

# Roofing Giant™

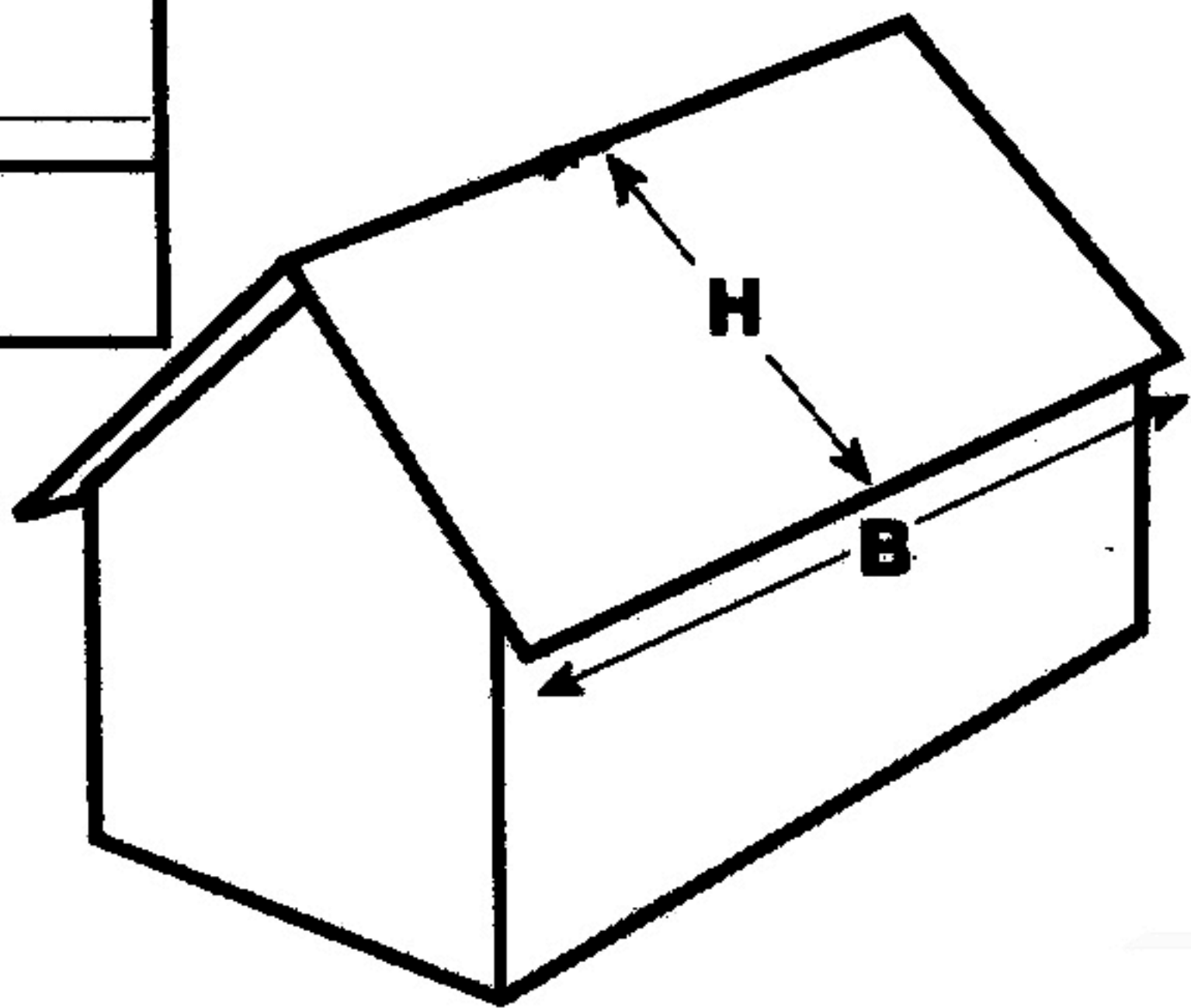

**Simple Gable Roof**

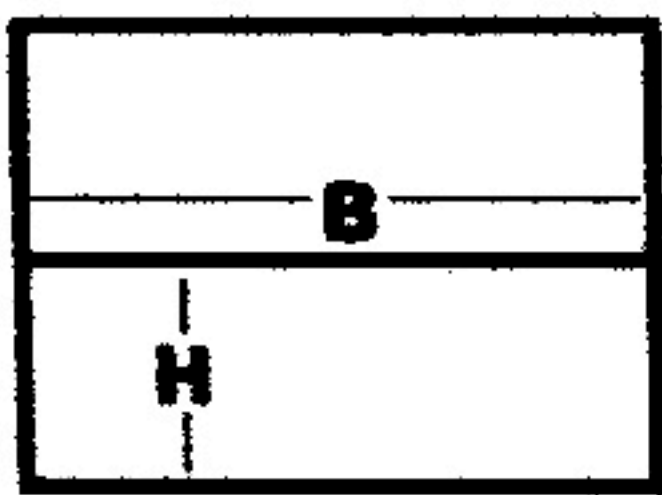
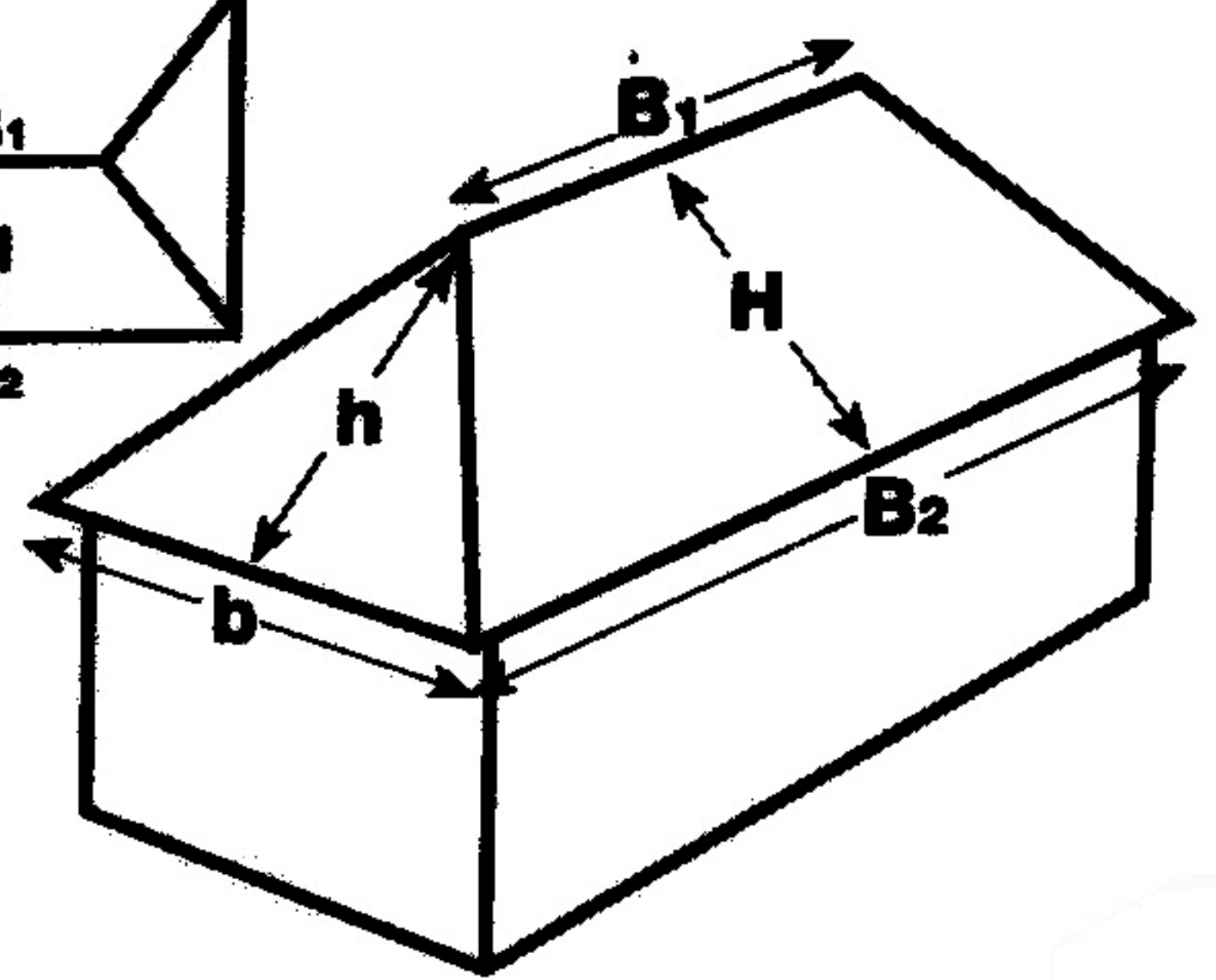
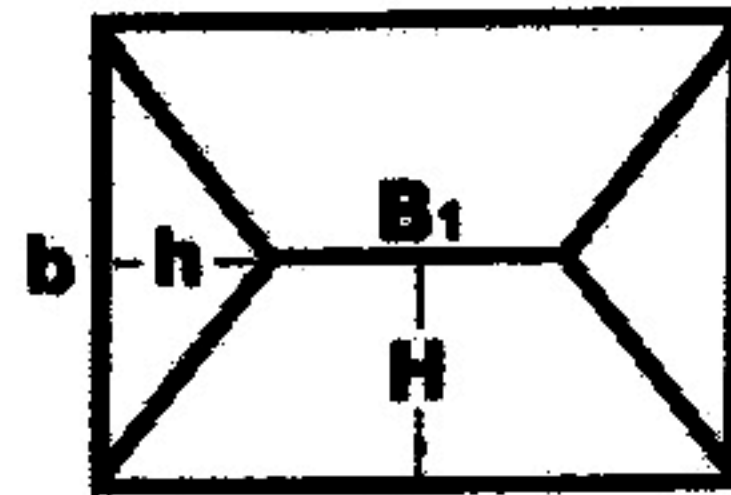

**Simple Hip Roof**

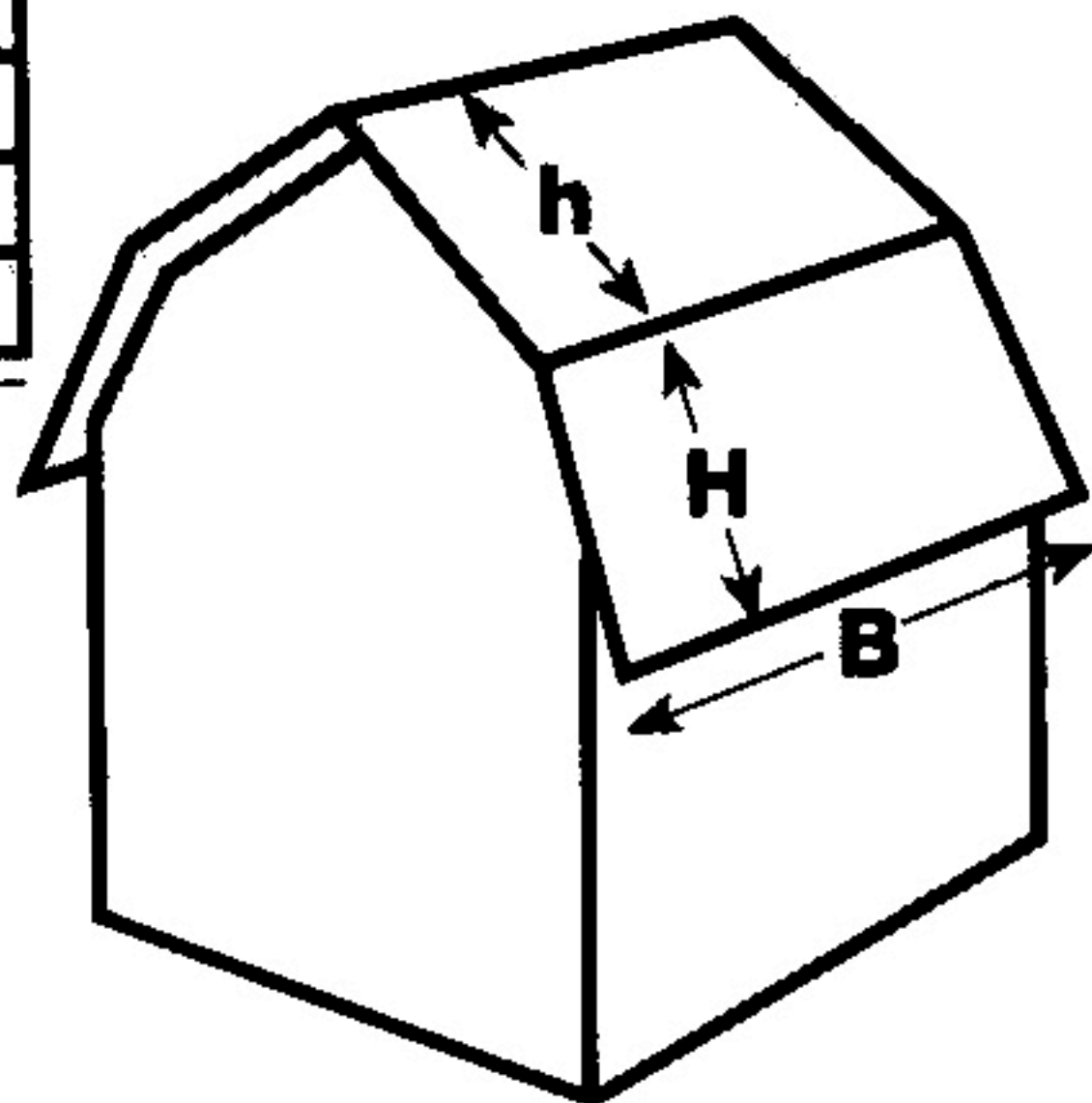
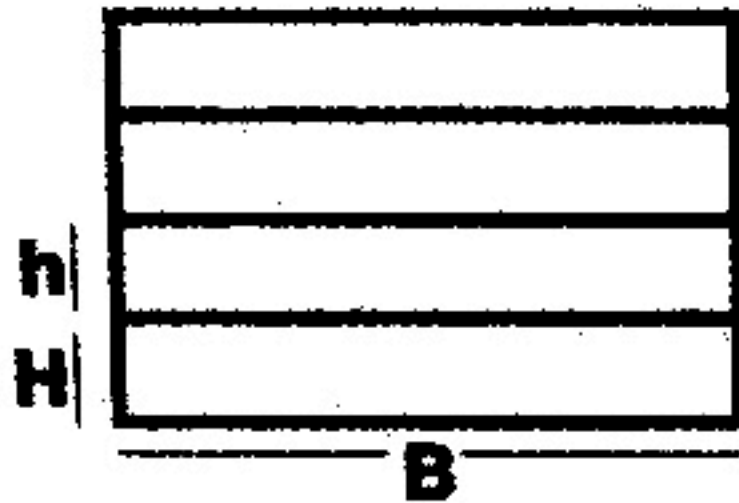

**Gambrel**

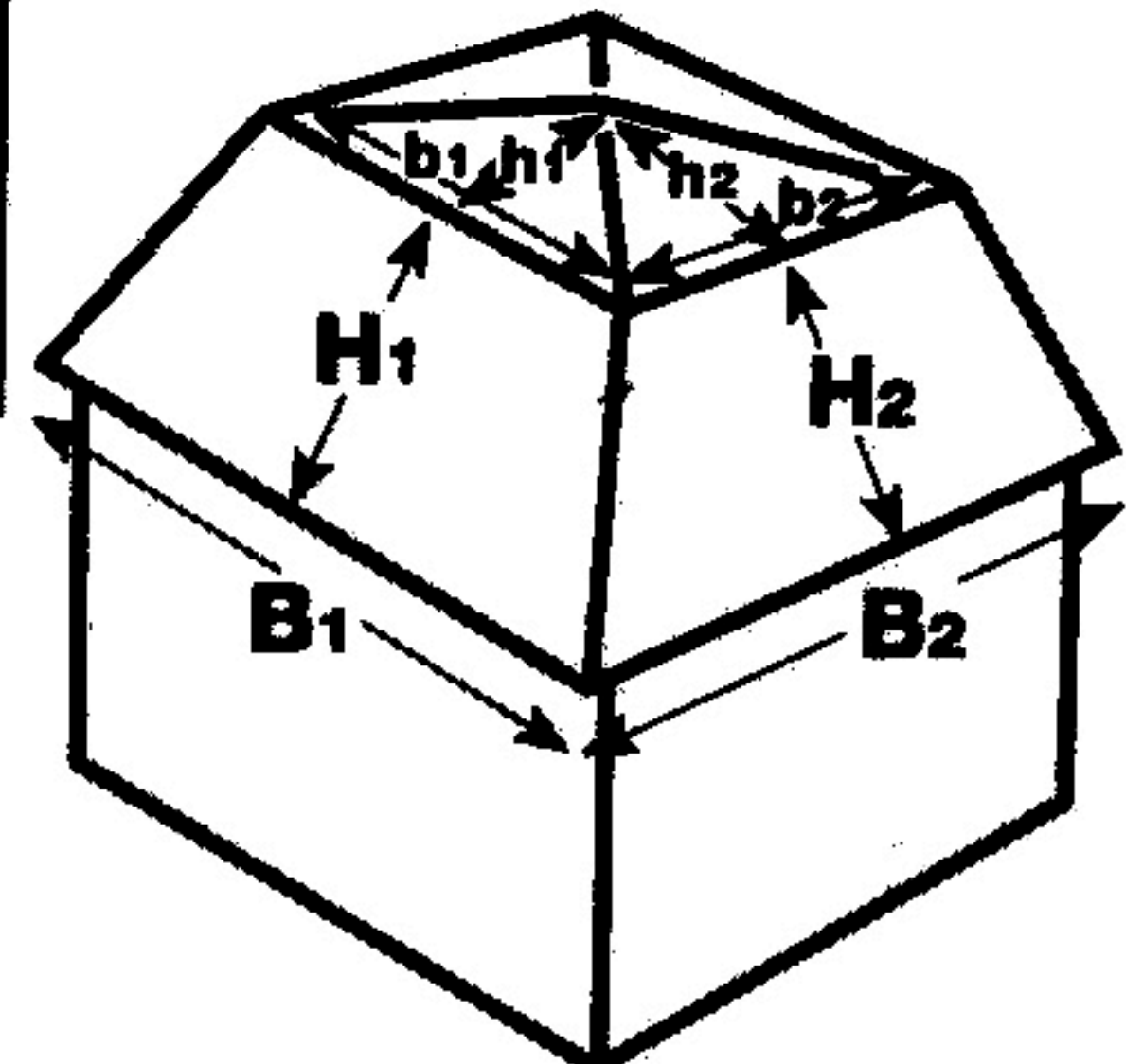
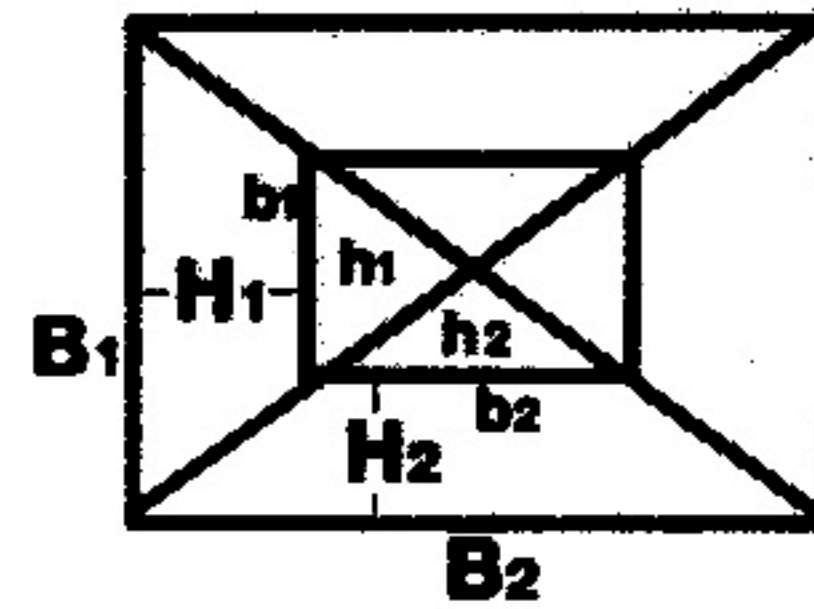

**Mansard**

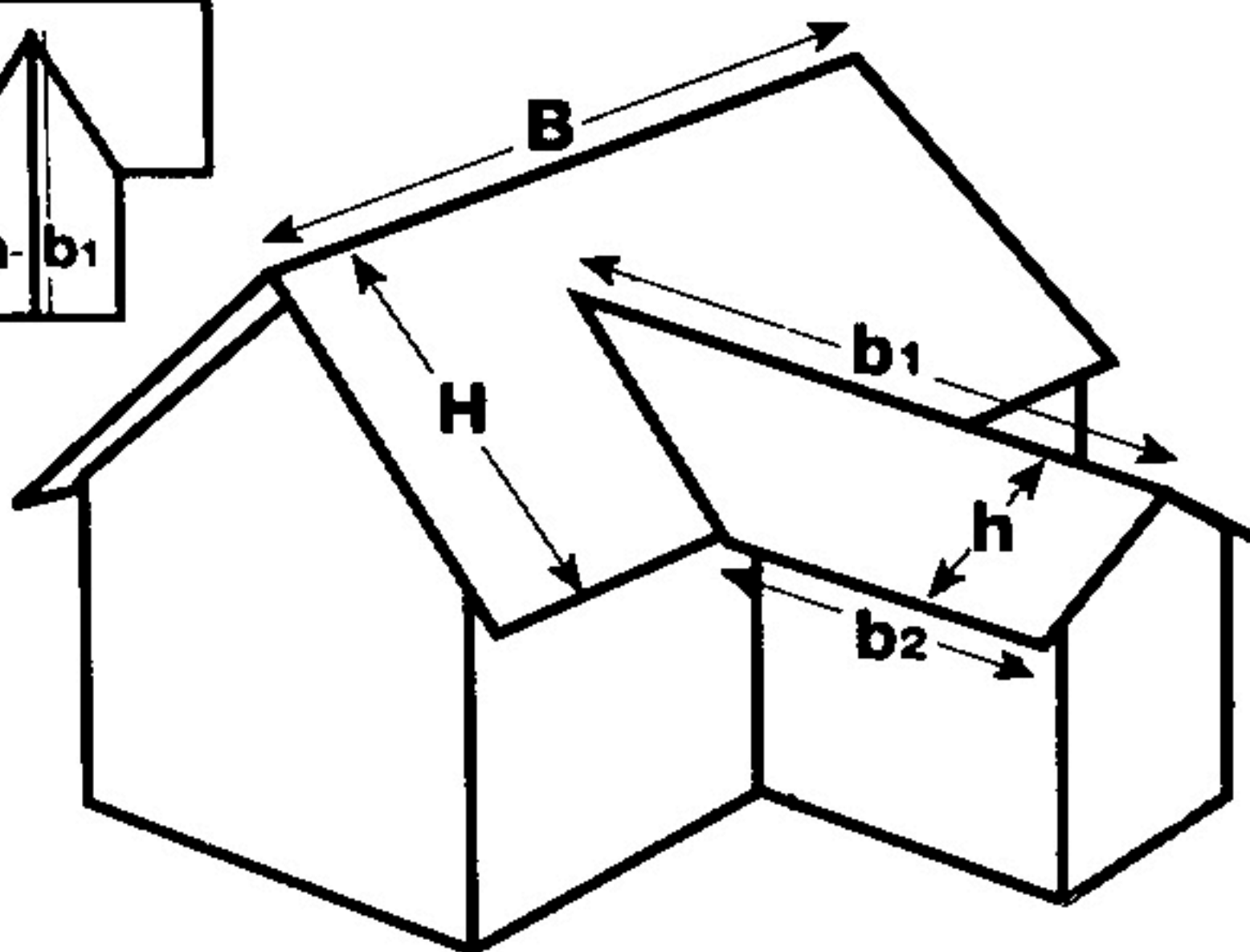
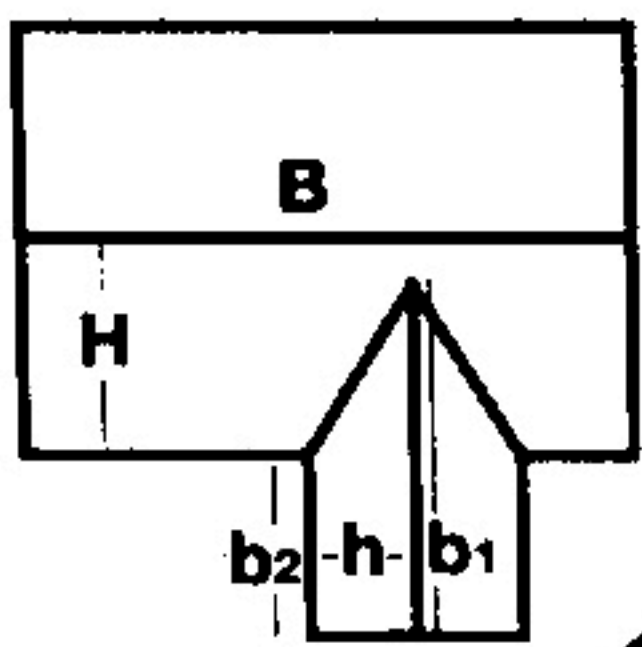

**Gable with Extension**

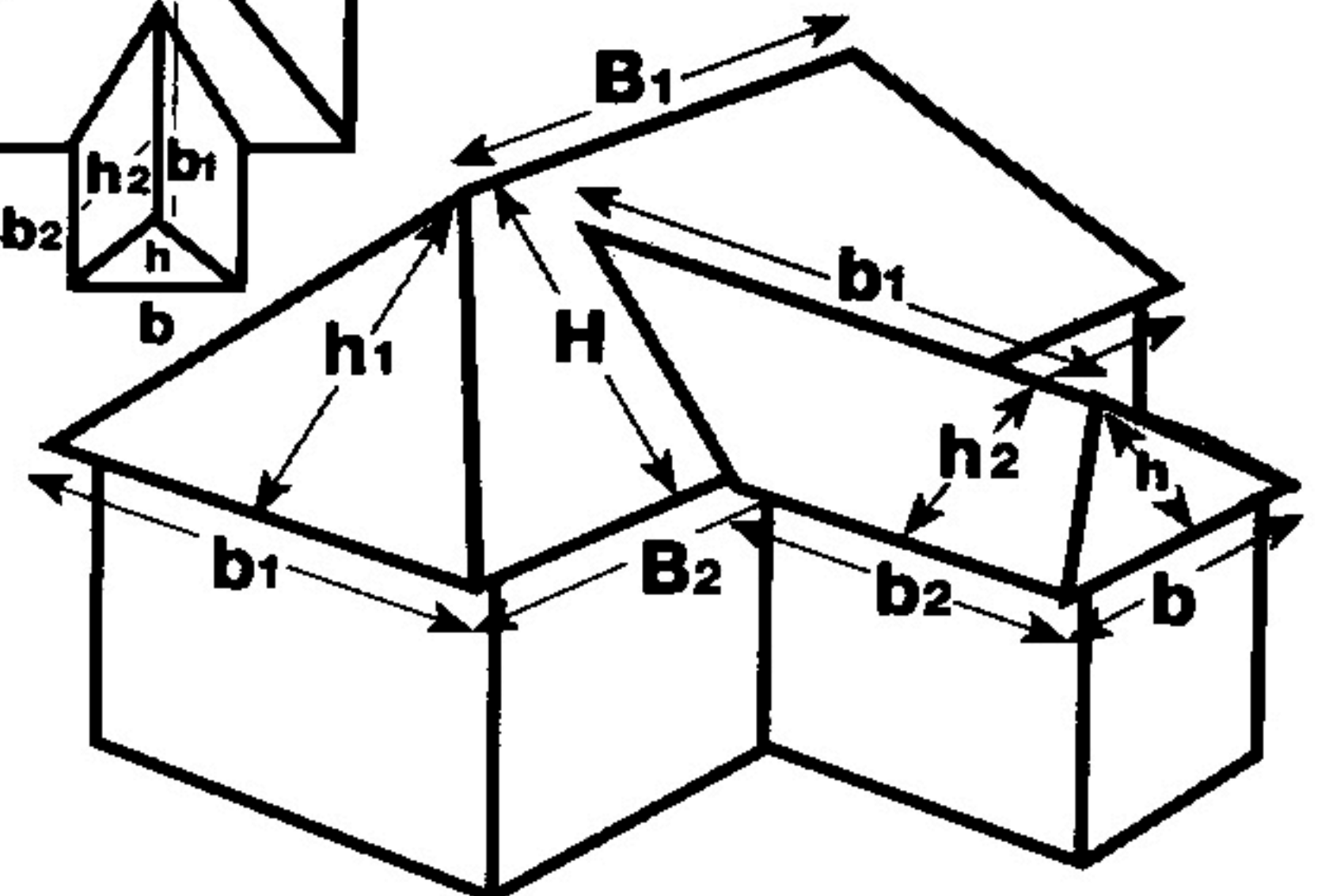
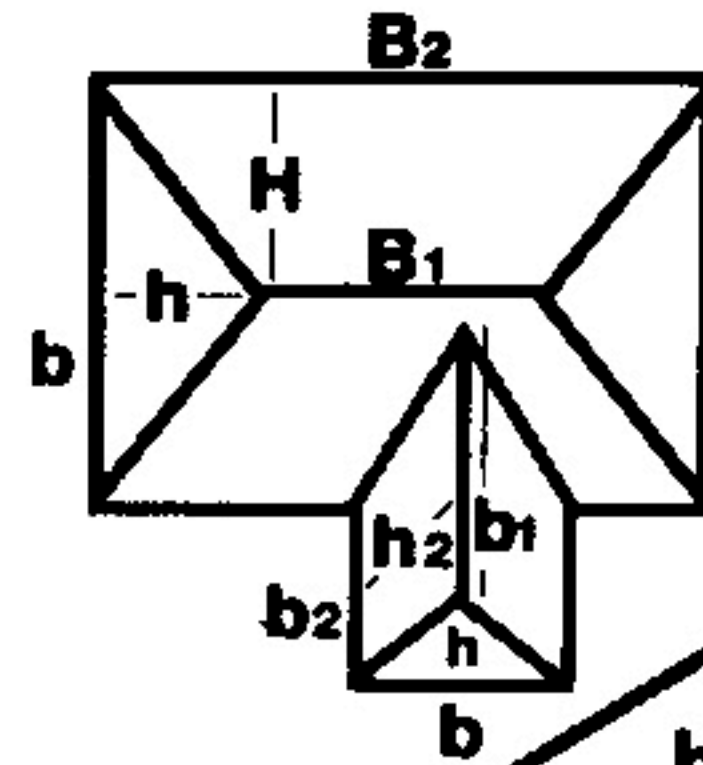

**Hip with Extension**

Add waste: Gable 10% Hip 15%  
Gambrel 10% Mansard 15%

This factor includes sufficient material for starters and caps. There may be additional costs for:

steep roof      2-story roof      number of cut ups

Composition shingles round up to nearest 1/3 square.  
Wood shingles or shakes: small-medium to 1/4 square  
large (>3/4") to 1/5 square

**Unit Measure to Use**

**SQUARE (SQ)**  
Shingles  
Felt

**LINEAR FOOT (LF)**  
Valleys  
Ridge vents/caps  
Interior trim  
Fencing  
Gutters  
Cabinets

**SQUARE FOOT (SF)**  
Siding  
Decking  
Drywall  
Painting  
Insulation  
Carpet cleaning  
Wallpaper (or by roll)

**SQUARE YARD (SY)**  
Carpet (12' rolls)  
Pad  
Vinyl flooring (12' rolls)

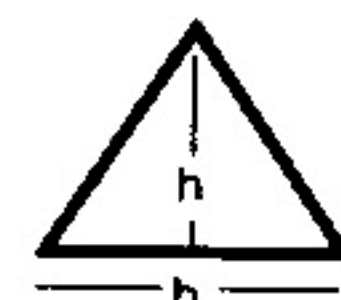
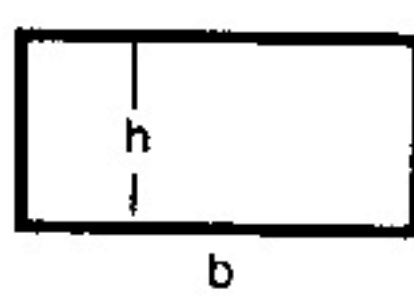
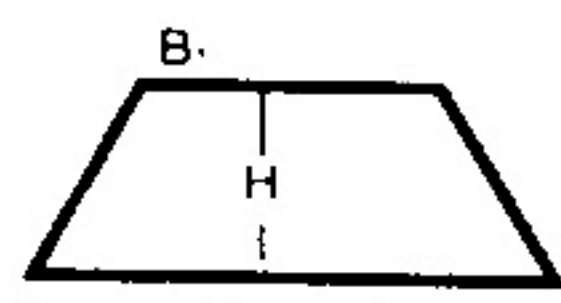
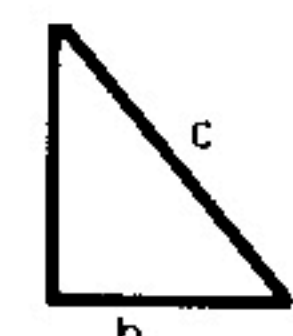
Area		
Triangle		$1/2 b \times h$
Square or Rectangle		$b \times h$
Trapezoid		$1/2 (B_1 + B_2) \times h$
Right Triangle (length of c)		$c = \sqrt{a^2 + b^2}$